



Time to turn the cards in your favour! An exciting experience emerges with Baccarat Evolution, offering a fresh new way to play on the go! With an intuitive interface, smooth graphics and engaging features, any time is a time to play. Come hit the table and get some fun.

ID: 10068

**DARWIN**



Global release

**FEBRUARY 17,  
2022**



RTP

**0%**



HIT Frequency

**0%**



Volatility

**LOW**



Default Max win

**0 €**



Paylines

**INFINITY**



Default bet size

**0,50 €**



Default bet range

**0,50 € - 35 €**



Default max multiplier

**X 0**

## Key selling points

Carefully designed for mobile devices so players can play in short bursts in everyday situations.

Light, Dark and Classic themes to fit the players light conditions and preferences.

Touch controls for more intuitive and easy play.

## Target demographic

Global reach, focused on mobile and quick play on the go.

Asian markets.

Table games lovers.

# Game features

## Themes

Baccarat Evolution offers three different themes selectable in-game. The players can switch between them at any time, to adapt their experience to any mood. The themes are named Light, Dark and Classic. The classic theme offers dealer's voice functionality.

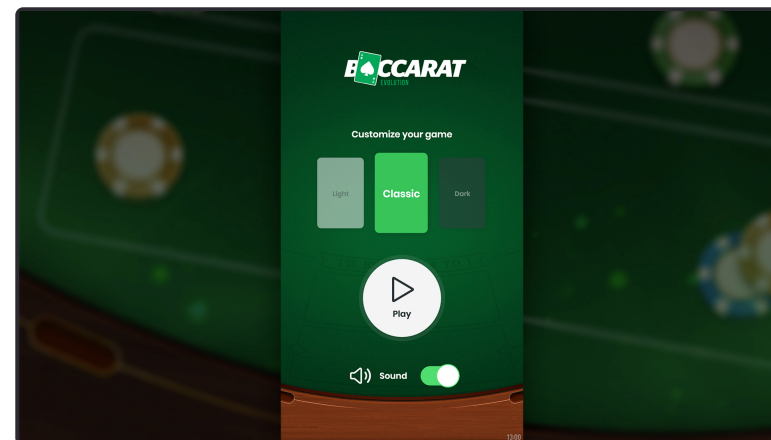

## Peak and Reveal

Peak and reveal feature allow a more immersive experience. The players can mimic the reality by manually control the act of revealing their cards.

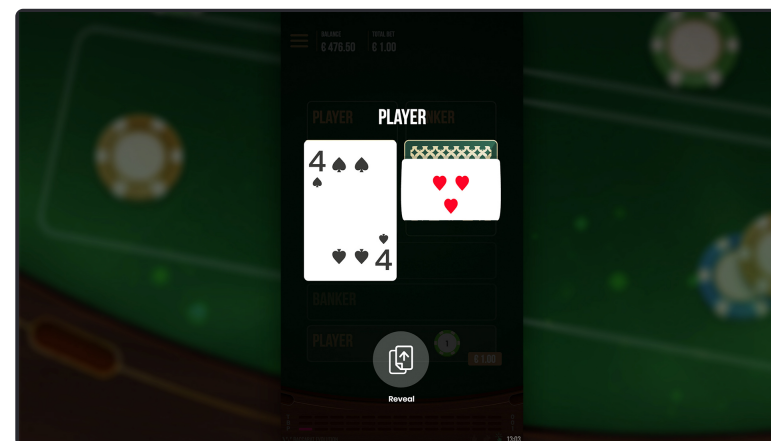

# Game rules

## RTP

Banker – 98.94%

Player – 98.76%

Tie – 85.64%

## Hit Frequency

Banker – 45.80%

Player – 44.62%

Tie – 9.52%

## Default Max Multiplier per Area

Banker – x70

Player – x70

Tie – x15

### **Payout per Area**

Banker – 1:1

Player – 1:1

Tie – 1:8

### **Examples for €1 Bet**

#### Banker and Player

The max. bet you can have on the Player/Banker with min. bet €1 is €70.

It pays 1:1 (the bet is returned), you get €70 (+€70)

#### Tie

The max. bet you can have on the TIE with min. bet €1 is €15

Tie pays 8:1 (bet is returned), so  $15 \times 8 = \text{€}120$  (+€15)

## **How to Play**

Place a bet.

Press the Deal button to start the game.

Two cards are dealt to the Player's game and two cards to the Banker's game alternately.

If the value of the Player's game is between 0 and 5, a third card will be dealt to it. According to the value of the third card and the score of the Banker's game, the dealer may also be dealt a third card.

## **Placing a Bet:**

Bets are placed by clicking or dragging the desired chip or by clicking on a betting area.

There are 3 betting areas and 5 chips.

The chip range is: 0.50, 1, 5, 10, 25 Euro or the closest equivalent in your chosen currency.

Players can bet the desired amount in each game (Player, Banker and Tie), as long as the minimum and maximum bet limits established by the game are respected.

Players can bet simultaneously on the chance of Player and Banker, as long as the difference in value between both bets is equal or higher than the minimum bet.

Players can rebet which sets the same Bet as their previous hand.

Bets are only final once the player clicks/taps on the deal icon or the timer runs out.

Chips on the table can be returned before the timer runs out by clicking/tapping on the clear or undo icon.

### **How to Win:**

The objective of the game is to predict which game – Player or Banker (Dealer) – will have the highest value, or whether there will be a tie.

The game score can have a maximum value of 9 and this is obtained after two or three cards are dealt.

If the Player has a game of value 8 or 9, it is considered to be a natural and automatically wins, unless the Banker's game also has 8 or 9.

### **How to Calculate Winnings**

A victory on a bet on Player or Banker's game has a payment of 1 to 1 and the original bet is returned.

A victory on a bet on Tie pays 8 to 1 and the original bet is returned.

If the result is a Tie but the player has bet on the Banker's or Player's victory, the player receives his

bet back.

In the case of a Banker victory whose score is 6 points, a commission of 50% is charged.

## **The Cards**

In this game, 8 decks of 52 cards each are used. The cards are always shuffled at the end of each round.

2 to 9 – Cards with these values have exact match in points.

Jack, Queen, King and 10 – The “figures” and 10 have a value of zero points.

Ace – Worth 1 point.

The suit has no influence on the game.

The third card is always distributed first to the Player's game and must respect the following scheme:

### 1st- The Player:

Has 0, 1, 2, 3, 4 or 5:

Receives 3rd card.

Has 6 or 7:

Does not receive any card / Stand.

Has 8 or 9:

Announced immediately.



## 2nd – The Banker:

Has 3:

Receives card if the Player receives: 1, 2, 3, 4, 5, 6, 7, 9 or 10

Doesn't receive card if the Player receives: 8

Has 4:

Receives card if the Player receives: 2, 3, 4, 5, 6 or 7

Doesn't receive card if the Player receives: 1, 8, 9 or 10

Has 5:

Receives card if the Player receives: 4, 5, 6 or 7

Doesn't receive card if the Player receives: 1, 2, 3, 8, 9 or 10

Has 6:

Receives card if the Player receives: 6 or 7

Doesn't receive card if the Player receives: 1, 2, 3, 4, 5, 8, 9 or 10

Has 7:

Does not receive any card / Stand

Has 8 or 9:

Announced immediately

Has 0, 1 or 2:

Receives card

Has 3, 4 or 5:

Receives card if Player doesn't receive any card

Has 6:

Doesn't receive card if Player doesn't receive any card

# Game menus

## Game Panel

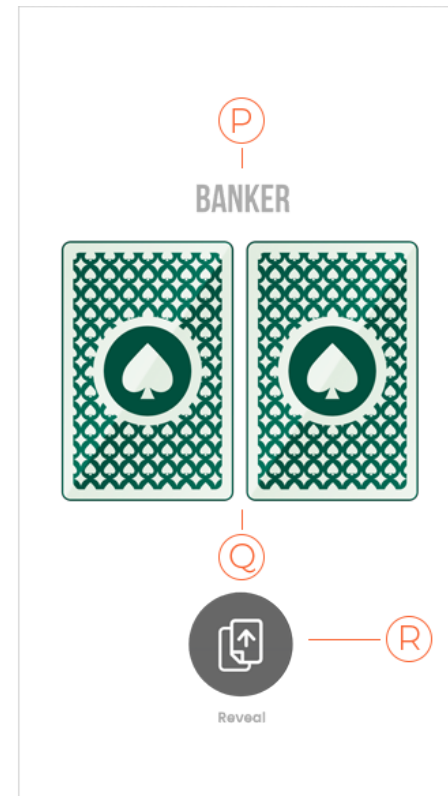
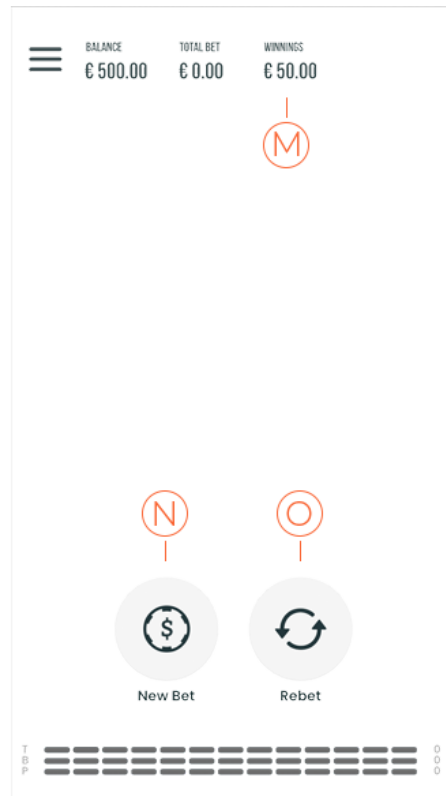
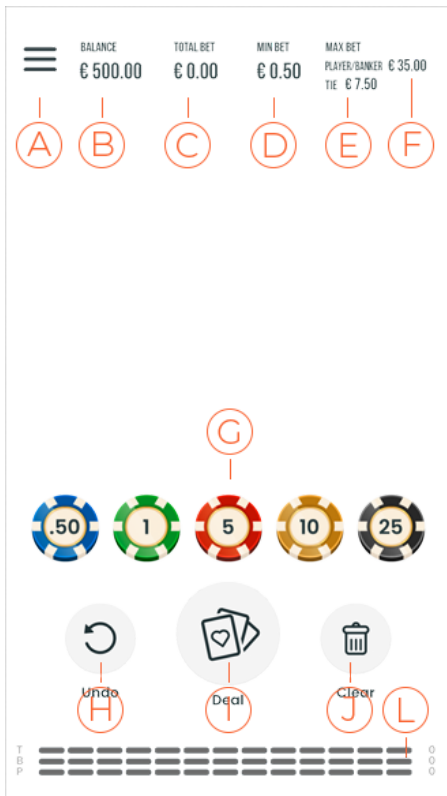

Expand this image

**A - Menu** - Access the menu.

- B - Balance** - Displays the player's account balance.
- C - Total Bet** - Displays the player's total bet.
- D - Min Bet** - Displays the game's minimum bet.
- E - Max Bet Tie** - Displays the tie's maximum bet.
- F - Max Bet Player/Banker** - Displays the player/banker's maximum bet.
- G - Chips** - Changes the bet value choosing whatever chip the player wants. Long select a chip and drag it to the desired betting area, then drop or select a chip and click on the desired betting area.
- H - Undo** - Undo the last action in the bets.
- I - Deal** - Proceed to the game.
- J - Clear** - Clear the bets made (remove all the chips).
- K - History** - Displays the last 13 game rounds outcomes's history.
- L - Winnings** - Displays the win for the current or last win payout step.
- M - New Bet** - Place a new bet.
- N - Re-Bet** - Place a bet equal to the previous one.

# Options Panel

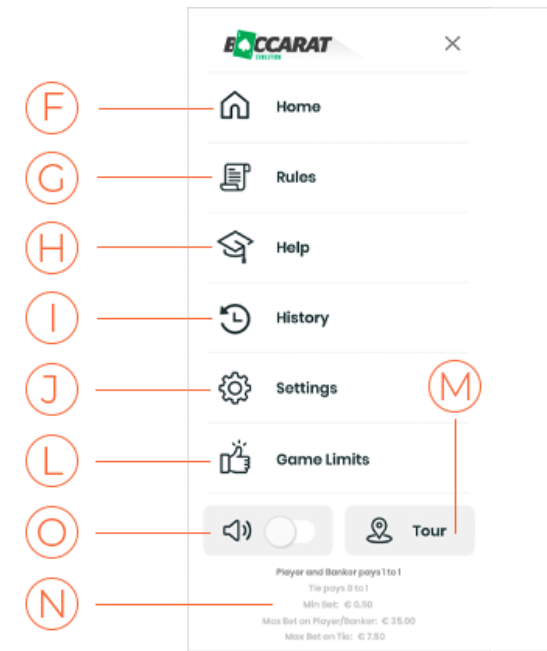
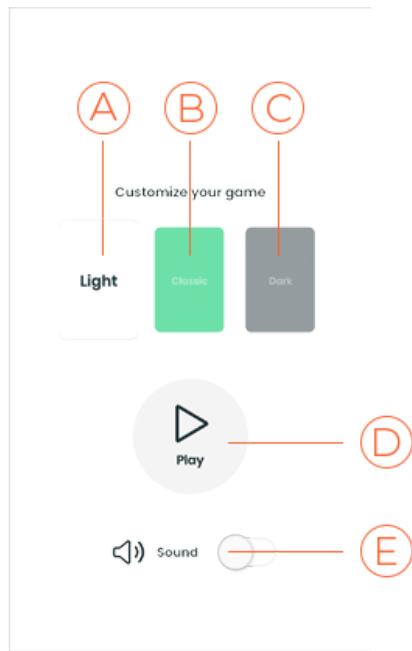

Expand this image

- A - Light Theme** - Setup game light theme.
- B - Classic Theme** - Setup game classic theme.
- C - Dark Theme** - Setup game dark theme.
- D - Play** - Proceed to the game.

- E - Sound** - Turn the sounds on or off.
- F - Home** - Goes back to the casino home page.
- G - Game Rules** - Opens the rules of the game.
- H - Game Help** - Opens the help of the game.
- I - Game History** - Displays all the last outcomes's history.
- J - Game Settings** - Changes the game speed, color theme, turn on manual turn cards and touch controls.
- K - Game Limits** - Changes time between plays, game session time and other settings.
- L - Tour Button** - Displays game tour.
- M - Paytable** - Find how much each prize pays out.
- N - Sound** - Turn the sounds on or off.